

New Medical Education Facility

Construction logistics



Project Schedule

- Mobilize to Site - March 2025
- Temp Loading Dock Construction - February 2025
- Close Brody Loading Dock - March 2025
- Begin Med Ed Building Construction - March 2025
- Begin Parking Deck Construction - March 2025
- Begin Chiller Plant Construction - Parking lot captured March 2025, Construction start August 2025
- Open Brody Loading Dock - August 2026
- Complete and Open Parking Deck - January 2027
- Complete Open Parking around Chiller Plant - July 2027
- Complete Building - August 2027
- Demobilize from Site - July/August 2027

Overall Site Plan

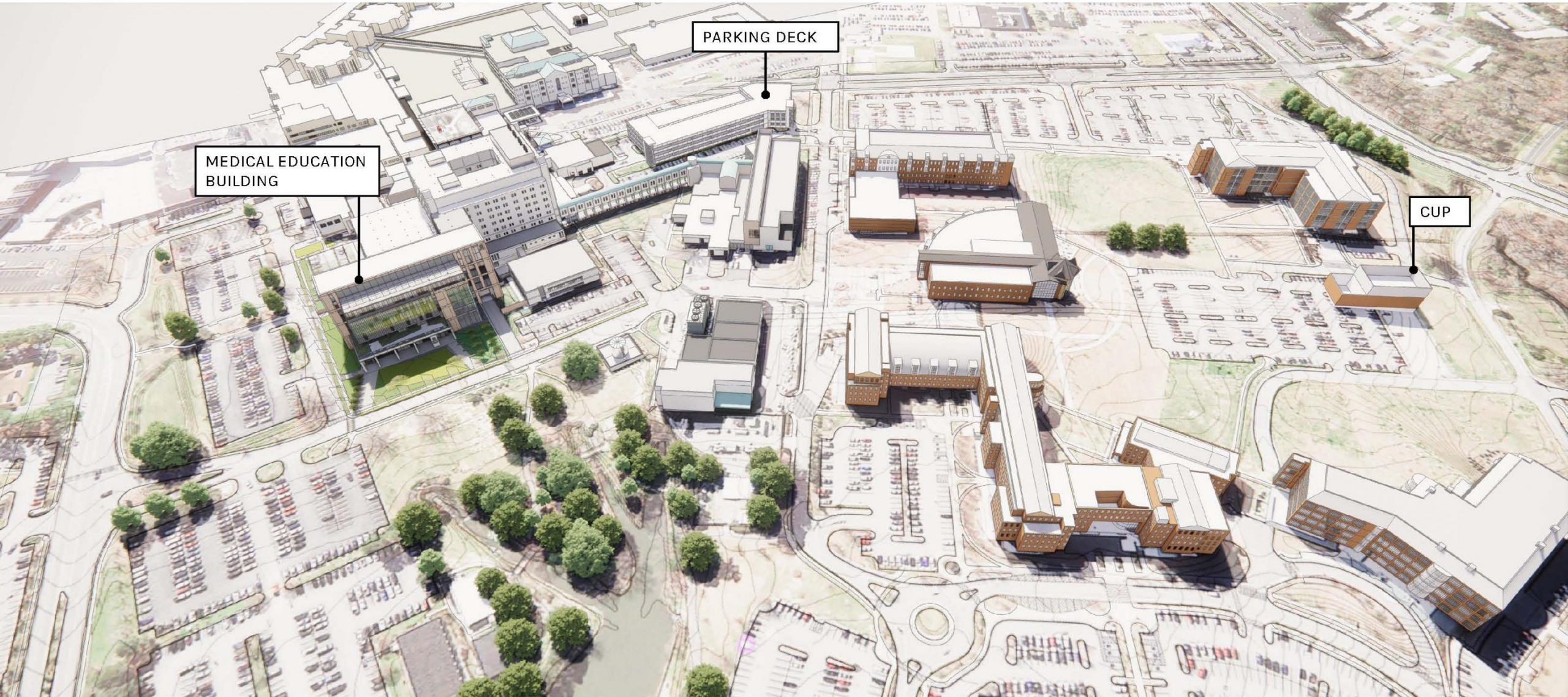

1A

ECU Health

Warren Life Sciences

Biotech

Chiller Plant

Temporary Stair Tower

Construction Fencing

Pedestrian Routing

Construction Traffic

1-Way Traffic with Barriers

Gate

Jobsite Office

Temporary Crosswalk

March 2025 - July 2027
Mobilization - MEB
Total Duration - 29 Months

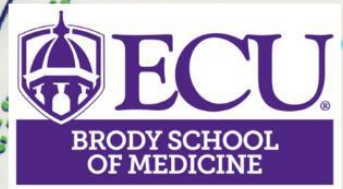

1C

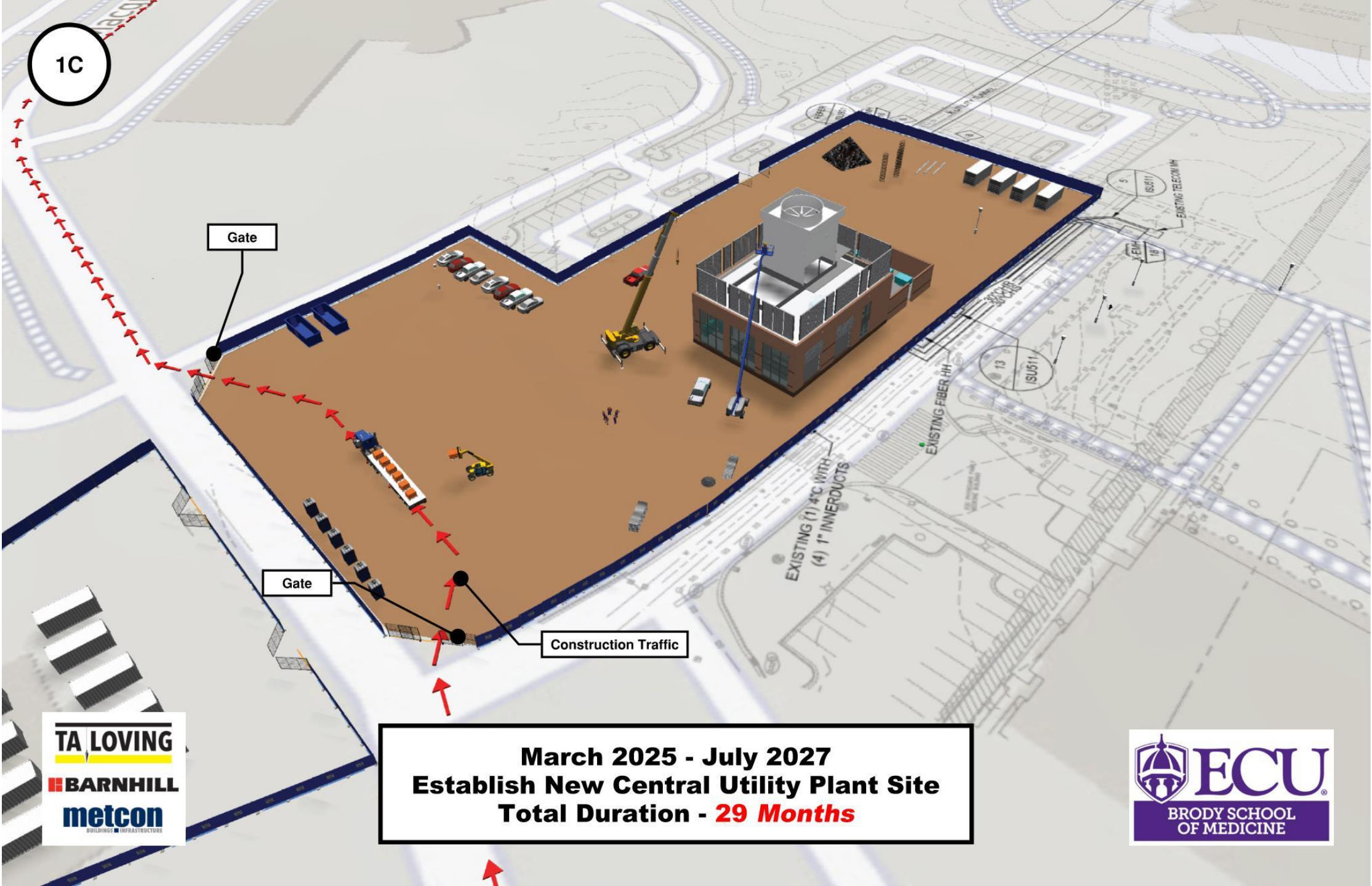

March 2025 - July 2027
Establish New Central Utility Plant Site
Total Duration - 29 Months

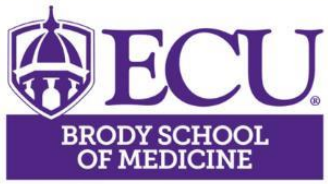

2A

ECU Health

Temporary Loading Dock (see 2B)

Parking to Remain Open and Accessible with Temp Road
14 Standard & 4 ADA Spaces Available

Underpinning at Existing Building

Loading Dock Closed

Fencing

Biotech

Warren Life Sciences

Gravel Lot for Parking and Deliveries

May 2025 - March 2026
Parking lot closed until site utilities / final paving are complete in this area.

Temporary Road for BioTech Access
April 14th Start

N. Campus Loop

Pedestrian Routing for Duration of Road Closure (see 2C)

March 2025 - June 2027
N. Campus Loop closed to normal traffic.
*August 2026, limited access for loading dock can resume.
*Coordinate with JV**



March 2025 - July 2026
Begin Loading Dock Shutdown
1 Month After Mobilization
Total Duration - 16 Months



Parking to Remain Open and Accessible with Temp Road
14 Standard & 4 ADA Spaces Available

Temporary Road for BioTech Access
April 14th Start

Construction Fencing

Phase 1 Steam Installation

Existing Utilities

August 2025 - March 2026
Parking lot closed until site utilities / final paving are complete in this area.

March 2025 - June 2027
N. Campus Loop closed to normal traffic.



2B



ECU Health - Brody Connector

Temporary Canopy

Temporary Loading Dock Area
Portable loading dock lift will be provided for loading/unloading

Rolloff Dumpster with Ramp Access and Gate

ECU Health

Leo Jenkins



**March 2025 - June 2027
Temporary Loading Dock
Total Duration - 28 Months**



2C

Warren
Life
Sciences

Existing Cup

Lake
Laupus

Pedestrian
Route During
Road Closure

*If needed, necessary
adjustments will be made to path
to provide ADA access*

W. Campus Loop



March 2025 - June 2027
Pedestrian Routing During North Campus
Loop Closure
Total Duration - 28 Months

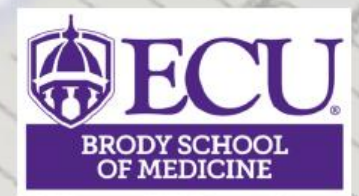

5

Construction Traffic

Gate

Warren Life Sciences

Temporary Road for BioTech Access

March 2025 - June 2027
N. Campus Loop closed to normal traffic.

No Parking in This Area

Pedestrian Access to Clinic and Gamma Knife

Crawler Crane

Gate

Heart Dr

Construction Fencing



March 2025 - December 2026
Establish Parking Deck Site
Total Duration - 17 Months

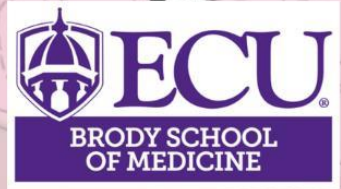

14A

Temporary
Clinic Drop-off
(see 15B)

Parking Lot
Paving
No Parking or
Traffic During
Paving

Pedestrian
Route for
Clinic / Gamma
Knife Access

Entrance
Closed

ROAD
CLOSED

Warren Life
Sciences

TA LOVING

BARNHILL

metcon
BUILDINGS INFRASTRUCTURE

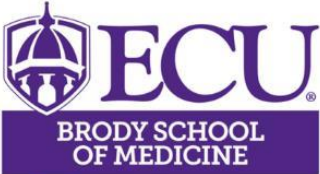

Temporary Stair Tower

Parking Lot Closed

No Access to Parking Lot

Construction Fencing

Gate

Pedestrian Routing

1-Way Traffic with Barriers

March 2025 - June 2027
N. Campus Loop closed to normal traffic.

November 2026 - April 2027
MEB Back End Sitework - Phase 1
6 Months
Parking Deck to Open January 2027

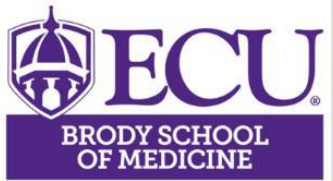

16

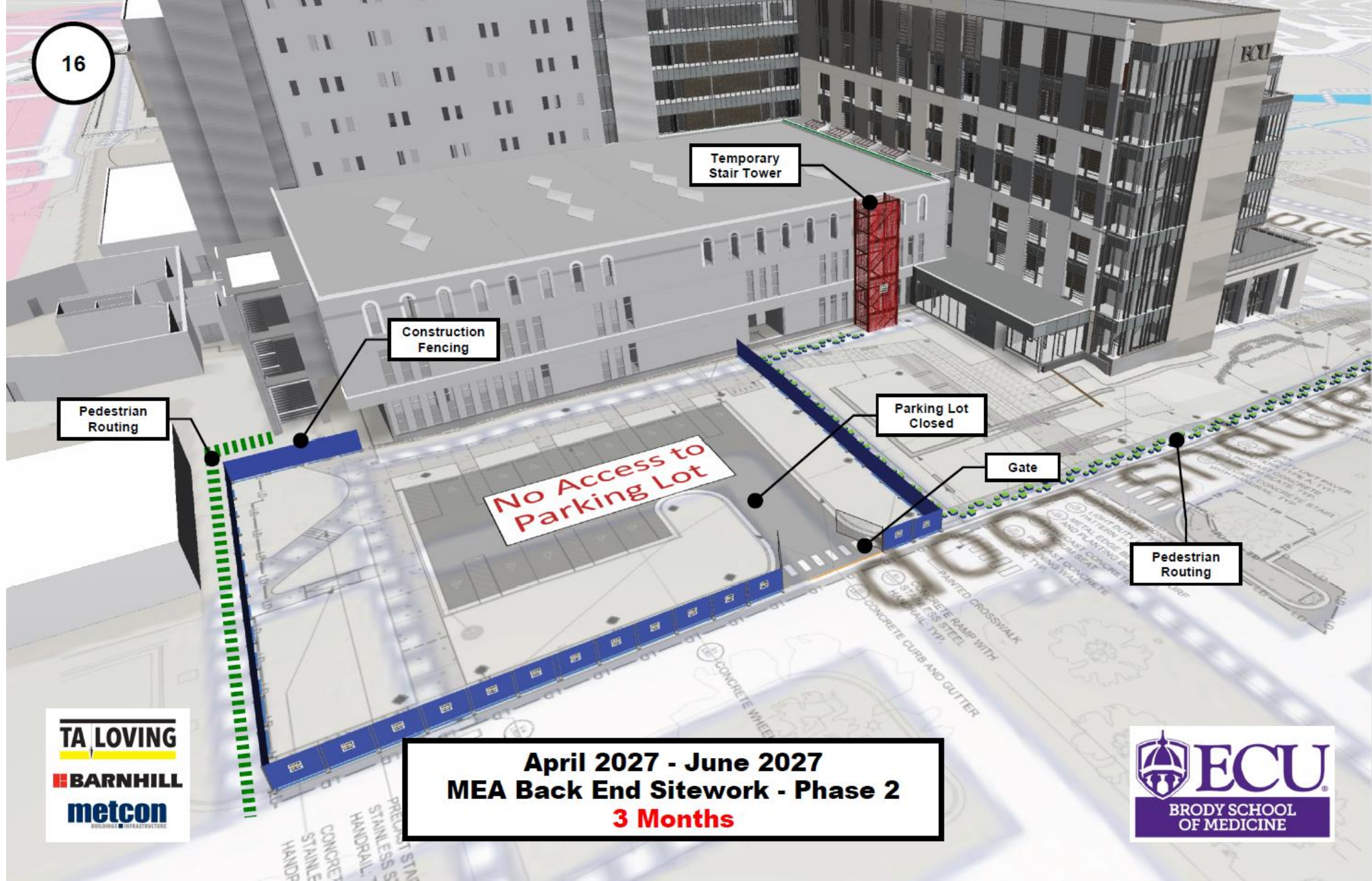

Temporary Stair Tower

Construction Fencing

Pedestrian Routing

Parking Lot Closed

Gate

Pedestrian Routing

No Access to Parking Lot



April 2027 - June 2027
MEA Back End Sitework - Phase 2
3 Months



Temporary
Stair Tower
Removed

N. Campus
Loop
Reopened

Complete
Sitework at
Temp. Stair
Location

Permanent
Pedestrian
Routing
Restored



July 2027
MEB Back End Sitework - Phase 3
2 Weeks

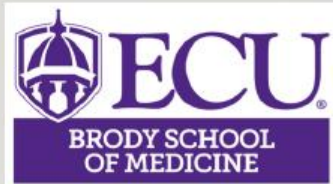

**Unoccupied - April 2025
Move in - August 2027**

Brody Ground Floor
Areas to be unoccupied during construction

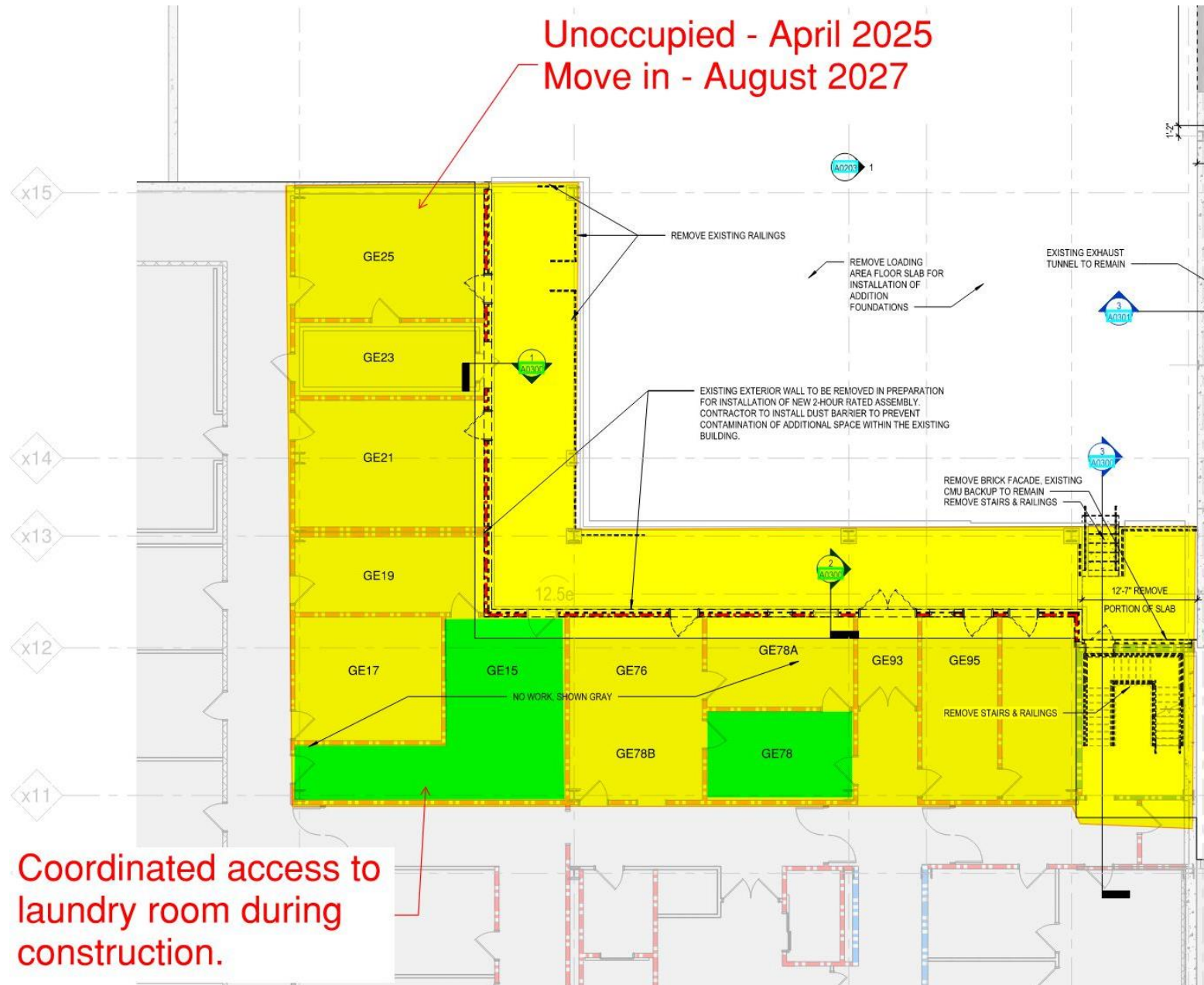

Coordinated access to laundry room during construction.

Brody First Floor

Areas to be unoccupied during construction

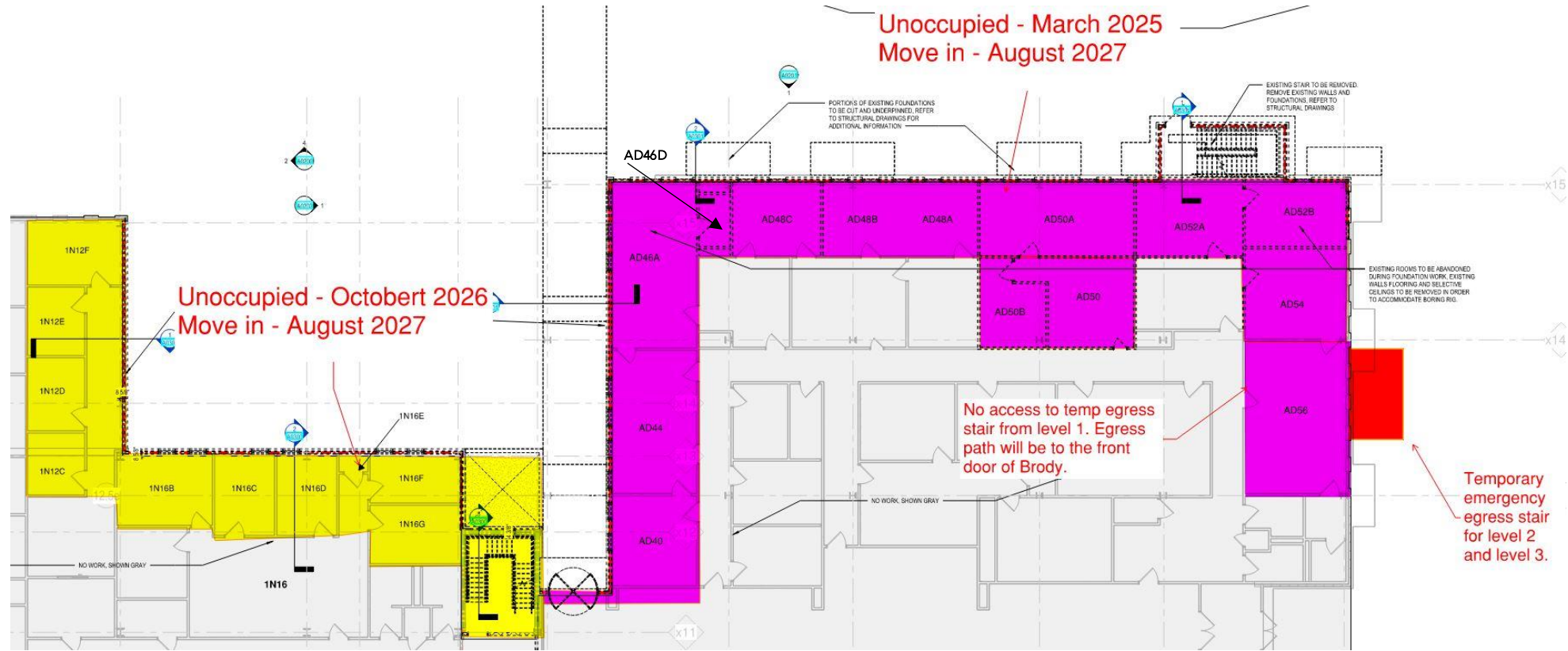

Brody
Second
Floor

Areas to be
unoccupied
during
construction

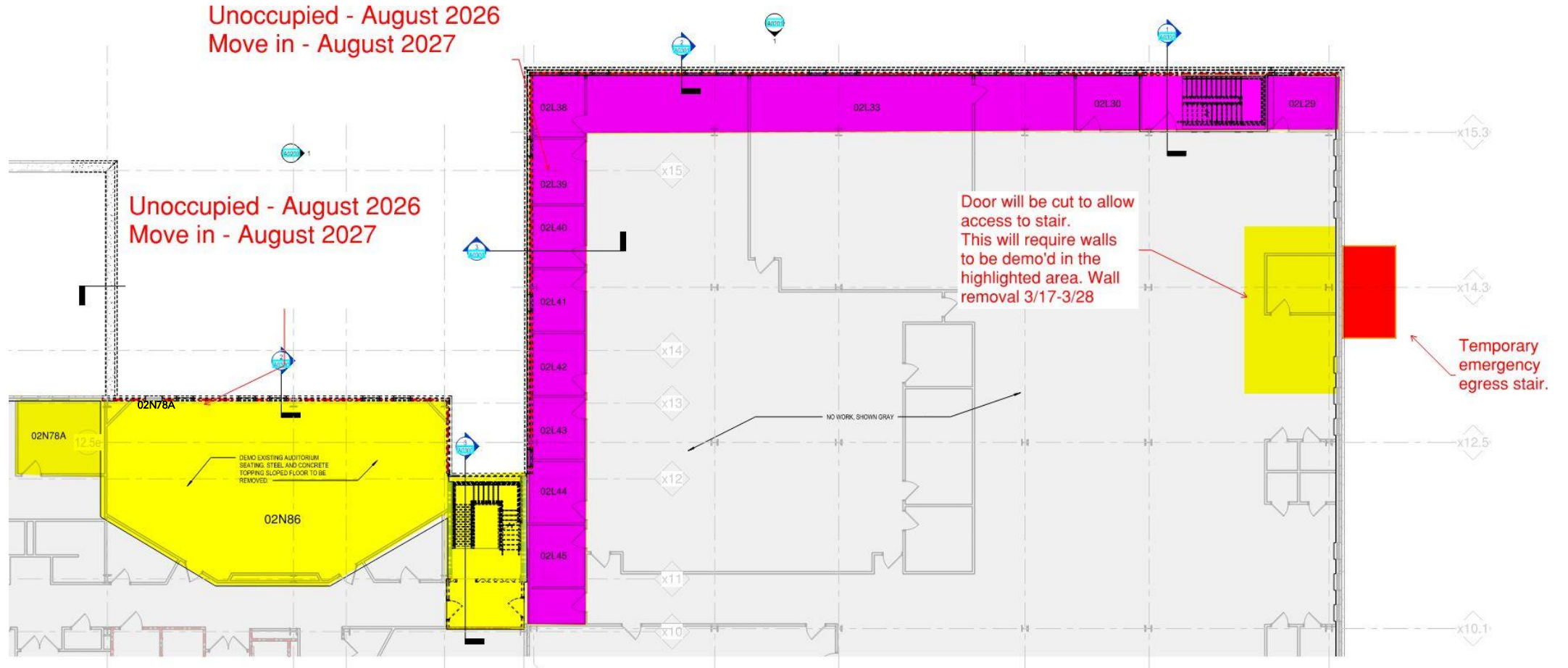

Brody
Third
Floor

Areas to be
unoccupied
during
construction

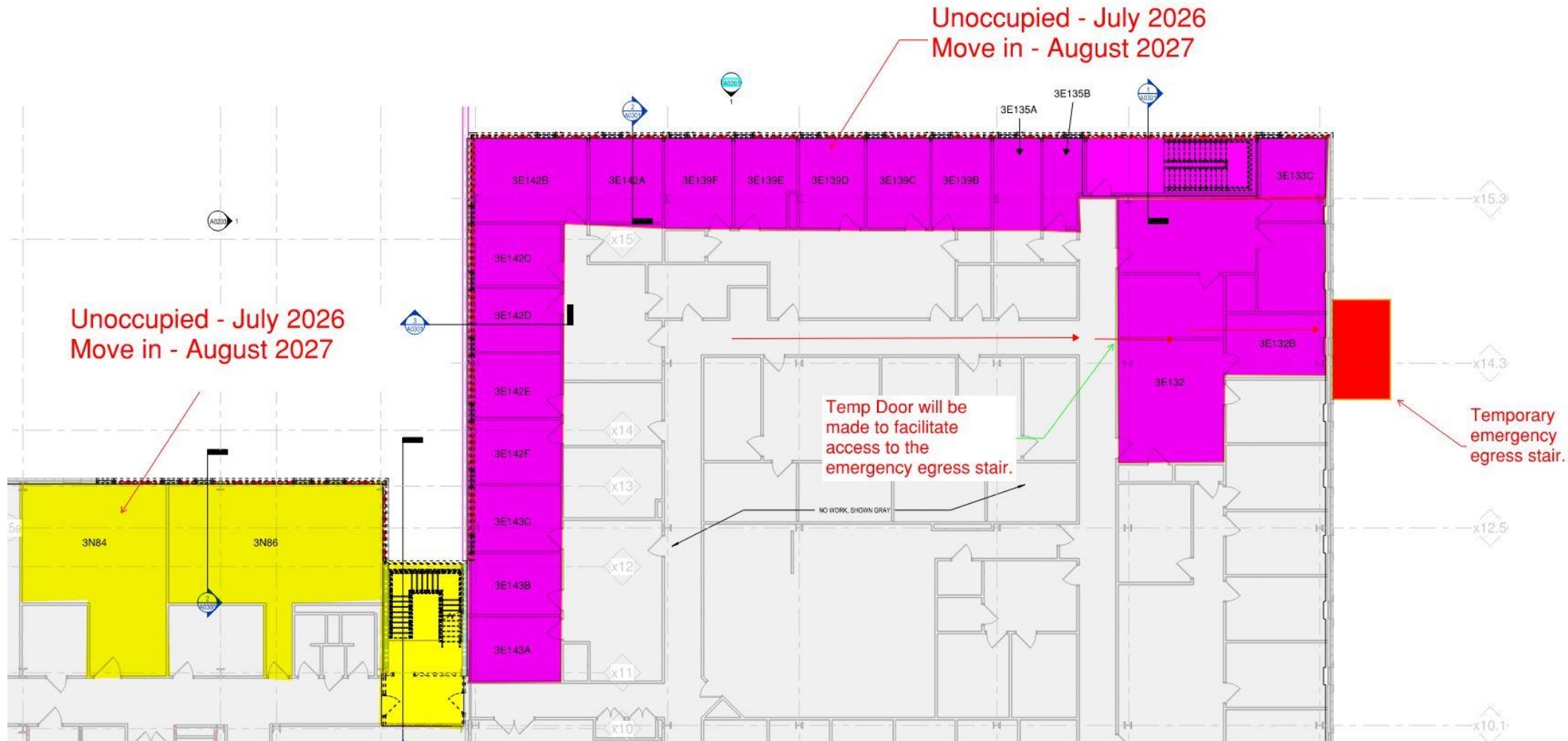

Brody
Fourth
Floor

Areas to be
unoccupied
during
construction

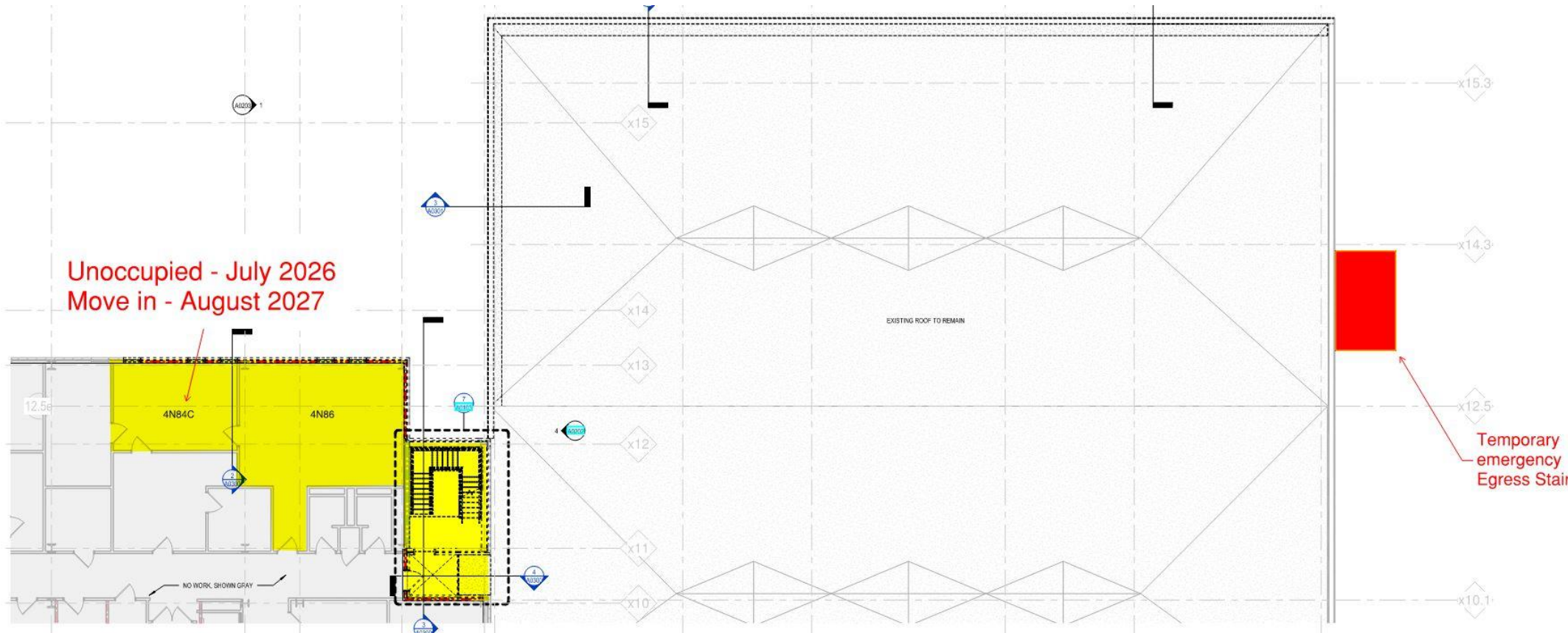

Unoccupied - June 2026

Move in - August 2027

Brody
Fifth
Floor

Areas to be
unoccupied
during
construction

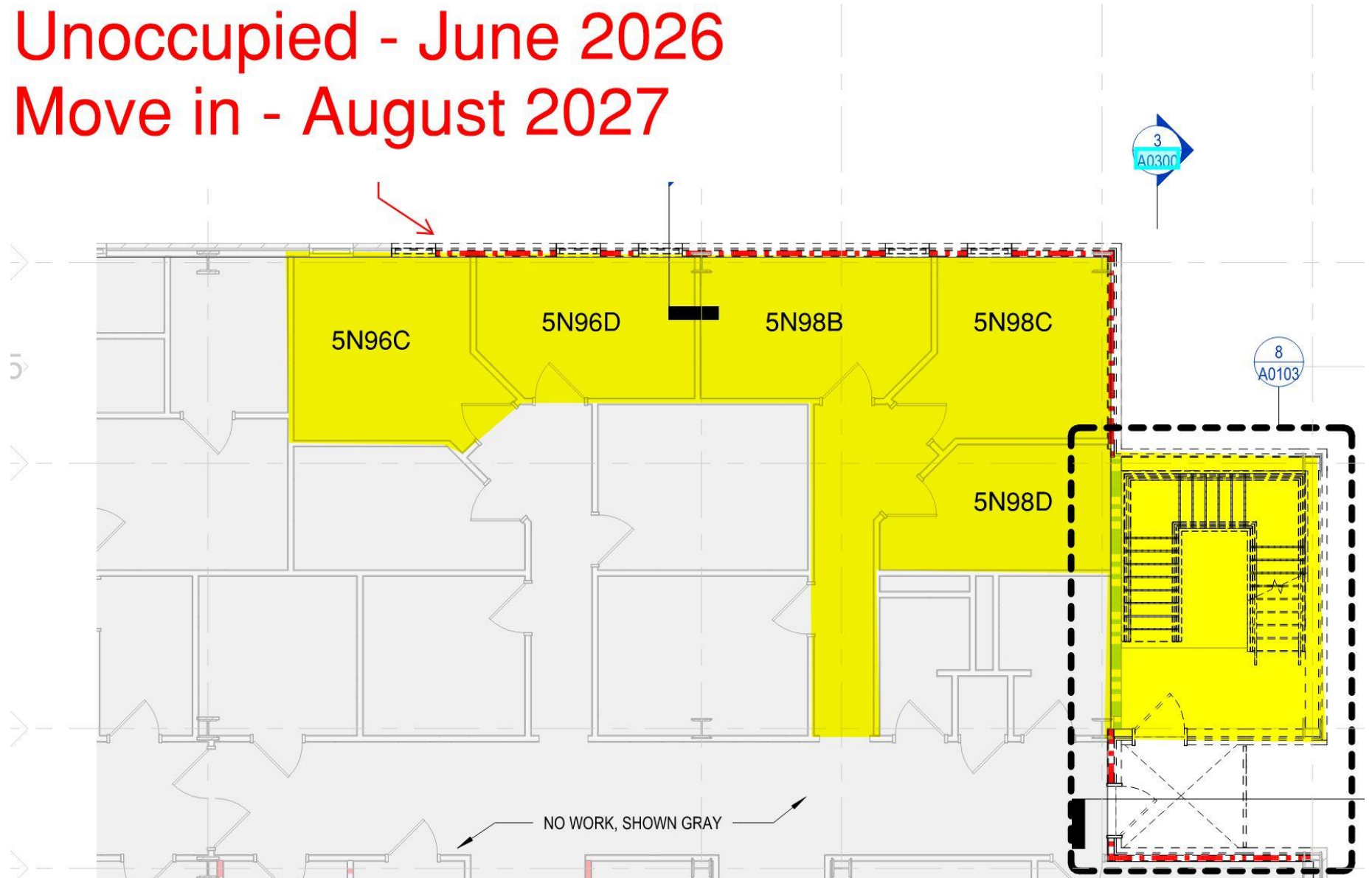

Unoccupied - May 2026 Move in - August 2027

Brody
Sixth
Floor

Areas to be
unoccupied
during
construction

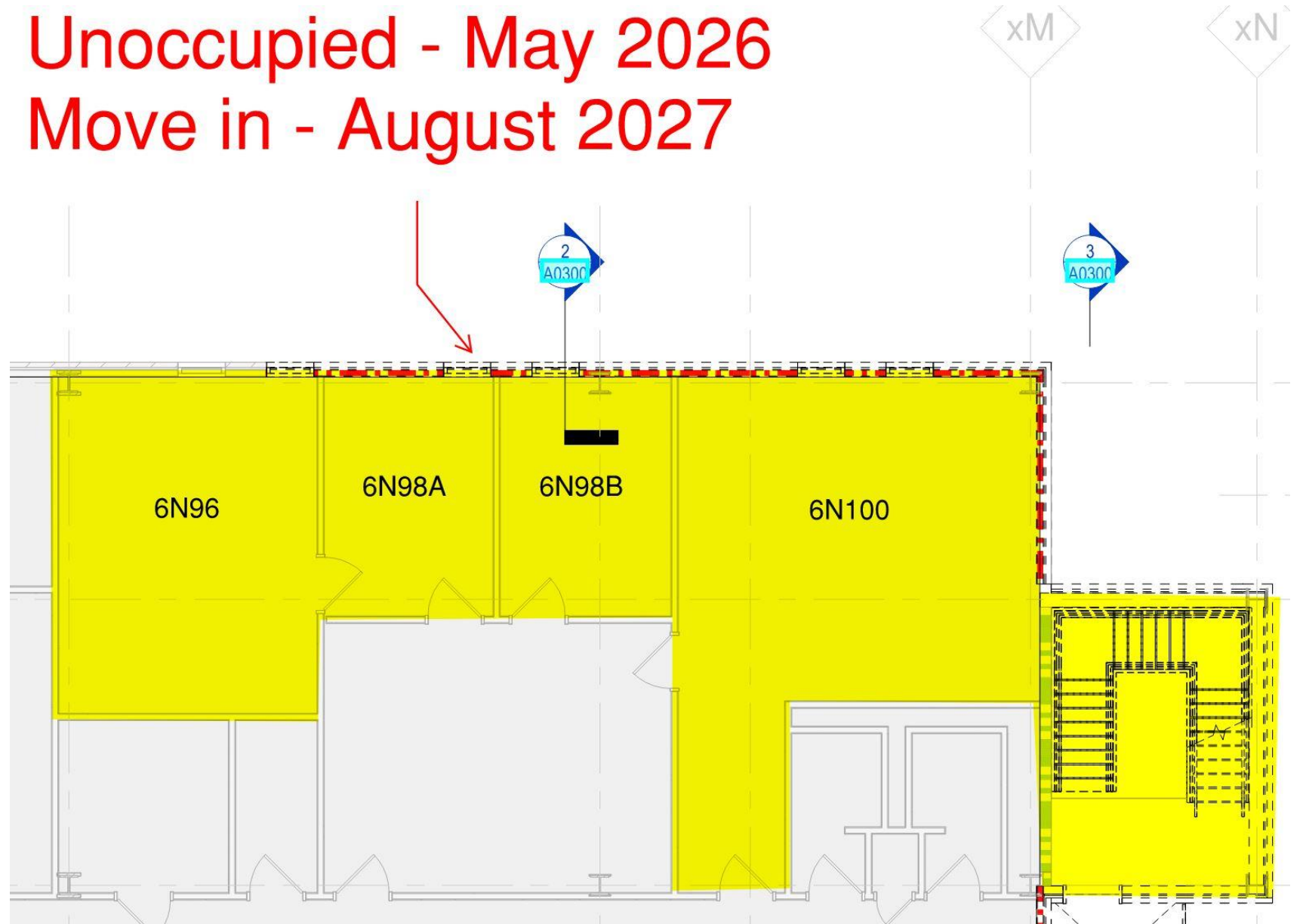

Unoccupied - May 2026 Move in - August 2027

Brody
Seventh
Floor

Areas to be
unoccupied
during
construction

Stair installation will cause noise during construction.

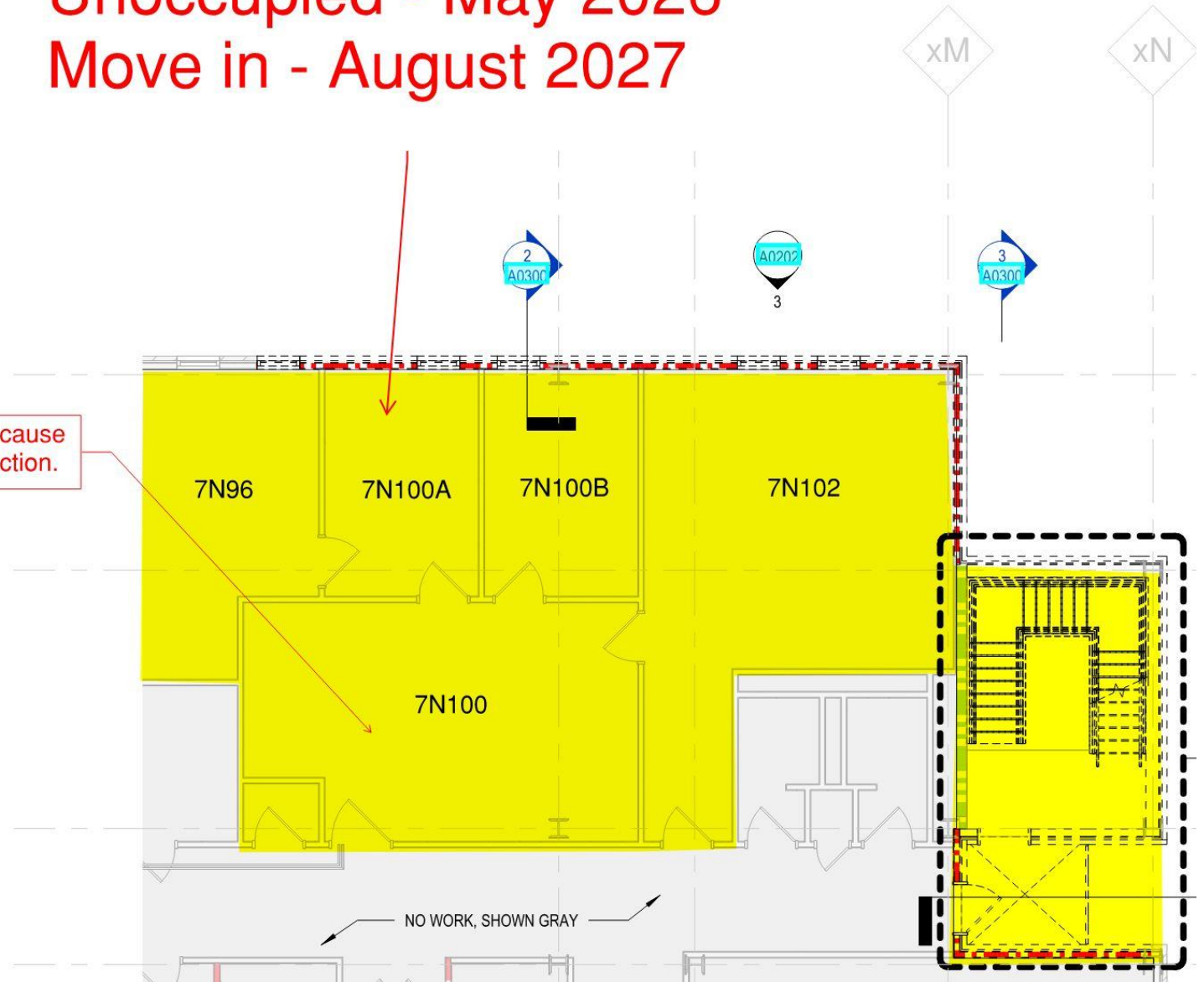

Brody
Eighth
Floor

Areas to be
unoccupied
during
construction

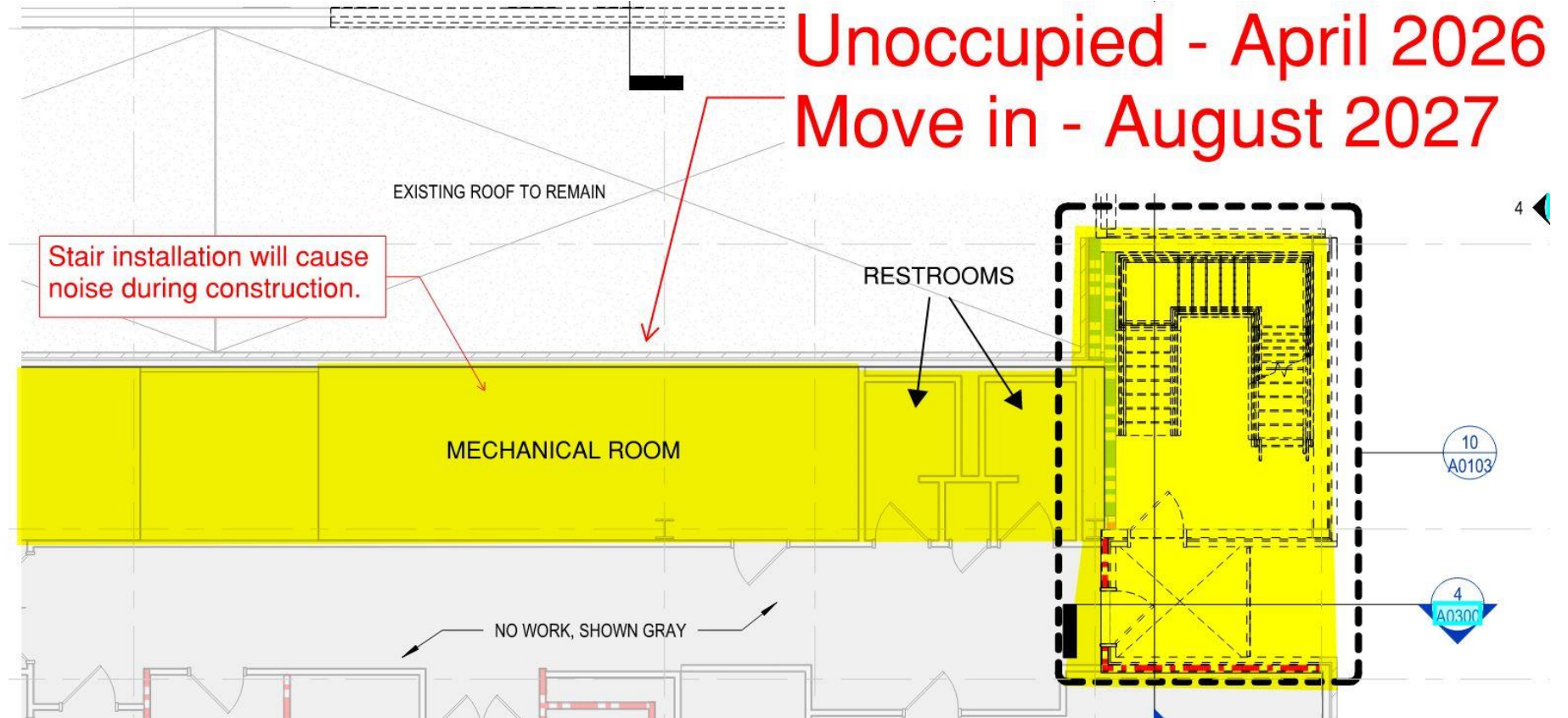

Temporary Gravel Parking Lot

Temporary gravel lot with 100 parking spaces between ECU Pediatric Cardiology and ECU Health Family Medicine.



Temporary Gravel Parking Lot

Legend

William E Laupus Health Sci Library

200 ft



ECU Brody School of Medicine New Medical Education Building Addition Parking Shutdown Plan

Temporary
ADA Parking



New Parking Deck
Location
Parking Lot
Permanently Closed

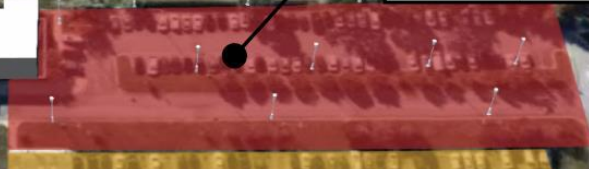

Parking In This Area
Temporarily Closed
To Reopen January
2027

New MEB Site
Parking Lot
Permanently Closed



ADA Parking



Biotech

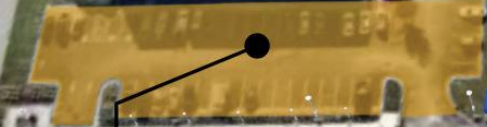

BioTech and Peds
Parking Temporarily
Closed
Will Reopen March
2026



Parking
Permanently Closed
at New CUP
Location

Parking Lot
Temporarily Closed
To Reopen August
2027



ECU Brody School of Medicine New Medical Education Building Addition Parking Shutdown Plan

Temporary
ADA Parking

New Parking Deck
Location
Parking Lot
Permanently Closed

Parking In This Area
Temporarily Closed
To Reopen January
2027

New MEB Site
Parking Lot
Permanently Closed

Clinic Parking
With ADA
Parking to
Remain Open

Biotech

Warren Life
Sciences

ECU Dumpster

ECHI

Will Reopen March
2026
Will Access From
Temporary Road

Temporary Road
for Biotech and
Clinic Access

N. Campus Loop
closed
To Reopen June
2027

